

CGB YA5 ALUM-Aluminum Box
CGB YA5 BLK-Black Steel Box
Installation Instructions for Yamaha G14/G16/G19/G22 Cargo Box



CAUTION: DO NOT TRANSPORT PASSENGERS IN CARGO BOX.

Kit Components:

Item # Description

- 1 Cargo Box
- 2 Cargo Box Channel
- 3 U-Bracket
- 4 Front Bracket
- 5 (2) 1" Square Tubing Caps *
- 6 Tailgate Rubber Latches
- 7 Tailgate Rubber Bumpers
- 8 Tailgate Hardware Kit
- 9 Hardware Kits

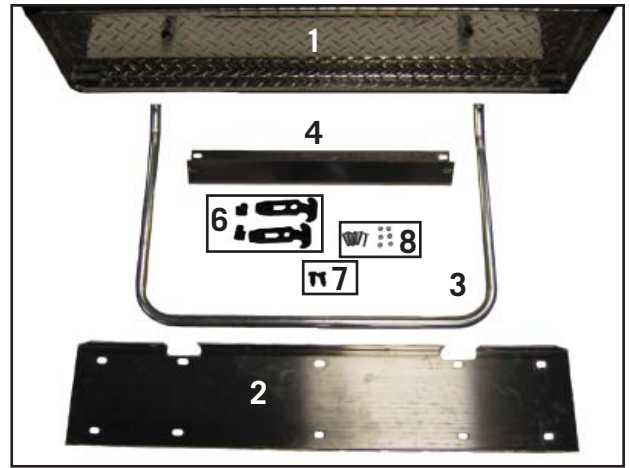

* Item 5 not shown

Hardware Kits Contain:

Bottom Channel Hardware Kit

- (6) 5/16"-18 x 1" Carriage Bolts
- (6) 5/16" Washers
- (6) 5/16"-18 Nyloc Nuts

U-Bracket Hardware Kit

- (2) 5/16"-18 x 3 1/2" Hex Head Bolts
- (2) 5/16"-18 x 1 3/4" Hex Head Bolts
- (8) 5/16" Washers
- (4) 5/16"-18 Nyloc Nuts

Front Bracket Hardware Kit

- (2) 5/16"-18 x 1 3/4" Hex Head Bolts
- (2) 5/16"-18 x 1" Hex Head Bolts
- (8) 5/16" Washers
- (4) 5/16"-18" Nyloc Nuts

Tools Needed:

- Hacksaw or Reciprocating Saw
- 1 1/32" Drill Bit
- Drill
- Phillips Head Screwdriver
- (2) 1/2" Wrenches

Optional Rear Strut Mounting Kit (sold separately from Cargo Boxes)

P/N: HDW YA5 RSTRT

Hardware Includes:

- (1) Rear Strut Bracket (Item 10, shown right)
- (6) 5/16"-18 x 1 3/4" Hex Head Bolts
- (12) 5/16" Washers
- (6) 5/16" Nyloc Nuts





CAUTION:

Always disconnect the negative (-) cable from the battery pack before beginning. If your cart is equipped with a Tow/Run switch, always switch to the TOW position before disconnecting the battery pack. Make sure you wear eye protection!

INSTALLATION INSTRUCTIONS:

1. Remove the rear seat back cushions, sweater basket, and the bag rack assembly from the cart.

Note: If equipped with a Canopy, prop a support beam up to keep the canopy shape from being distorted and remove the rear struts.

2. Cut off the seat back bracket, leaving approximately 1" of bracket AFTER the top curve (Figure 1).

3. File the edges to remove burs and install the two Square Tubing Caps (Item 5).

NOTE: Leave all hardware loose for easy installation.

4. Bolt the Cargo Box Channel (Item 2) onto the bottom of the Cargo Box (Item 1) with slots facing away from the tailgate. Use six 5/16"-18 x 1" Carriage Bolts, six Washers, and six Nyloc Nuts (Figure 2).

5. Use two 5/16"-18 1 3/4" Hex Head Bolts, two Washers, and two Nyloc Nuts to mount the U-Bracket (Item 3) to the Cargo Box (Item 1) (Figure 3).

6. Install the Cargo Box Front Bracket (Item 5) to the Cargo Box (Item 1) with the widest side of angle against the cargo box using two 5/16"-18 x 1" Hex Head Bolts, two Washers, and two Nyloc Nuts (Figure 4).

7. Remove the original bolts from the golf bag well and re-drill the two holes to be 1 1/32" in diameter (Figure 5).

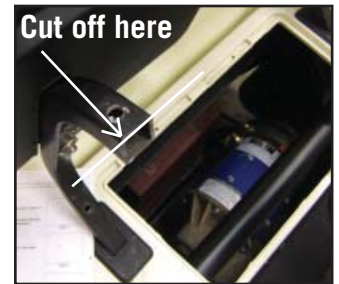

Figure 1



Figure 2



Figure 3



Figure 4



Figure 5

8. Align the Cargo Box on the cart and mark holes on the seat back brackets. Drill 1 1/32" holes (Figure 6).



Figure 6

9. Bolt the Cargo Box to the seat back brackets using two 5/16"-18 x 1 3/4" Hex Head Bolts, two Washers, and two Nyloc Nuts.

10. Bolt the U-Bracket (Item 3) to the golf bag well using two 5/16"-18 x 3 1/2" Hex Head Bolts, two Washers, and two Nyloc Nuts (Figure 7).



Figure 7

11. Locate the Tailgate Rubber Latch (Item 7) and mount with included hardware (Figure 8).



Figure 8

12. Twist the Tailgate Rubber Bumpers (Item 8) into place (Figure 9).

NOTE: Tighten all hardware securely.



Figure 9

Optional Canopy Installation with Strut Mounting Kit (sold separately):

P/N: HDW YA5 RSTRT

1. Center the Rear Strut Bracket (Item 10) to the top of the seat back bracket with holes facing upwards and mark two holes in seat back bracket (Figure 10).



Figure 10

2. Drill two 11/32" holes as marked in the seat back bracket.

3. Bolt the Rear Strut Bracket (Item 10) to the seat back bracket with two 5/16"-18 x 1 3/4 Hex Head Bolts, two Washers, and two Nyloc Nuts (Figure 11).

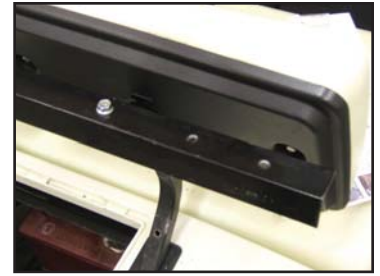

Figure 11

4. Cut off the last curve of the Rear Struts (Figure 12). Make sure there is enough room left to mount to the Rear Strut Bracket (Item 10).



Figure 12

5. Place the rear struts underneath the Rear Strut Bracket (Item 10) and mark two holes per side (Figure 13).



Figure 13

6. Drill two 11/32" holes per side in the rear struts and mount them to the Rear Strut Bracket (Item 10) using two 5/16"-18 x 1 3/4" Hex Head Bolts, two Washers, and two Nyloc Nuts per side.

NOTE: The rear struts should be bolted to the TOP of the Rear Strut Bracket (Item 10)!

